

*Barni 44*

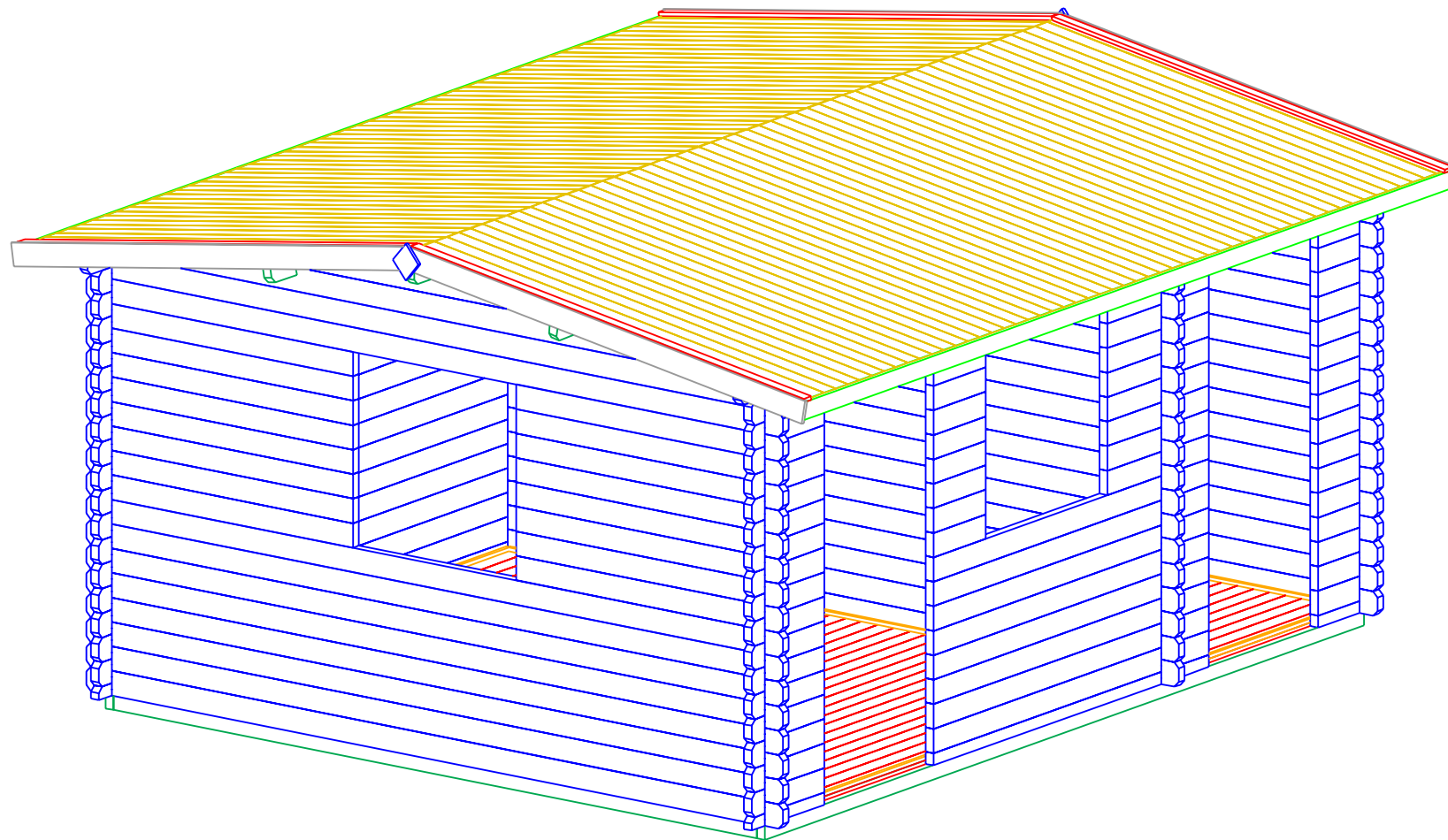

*Barni 44*

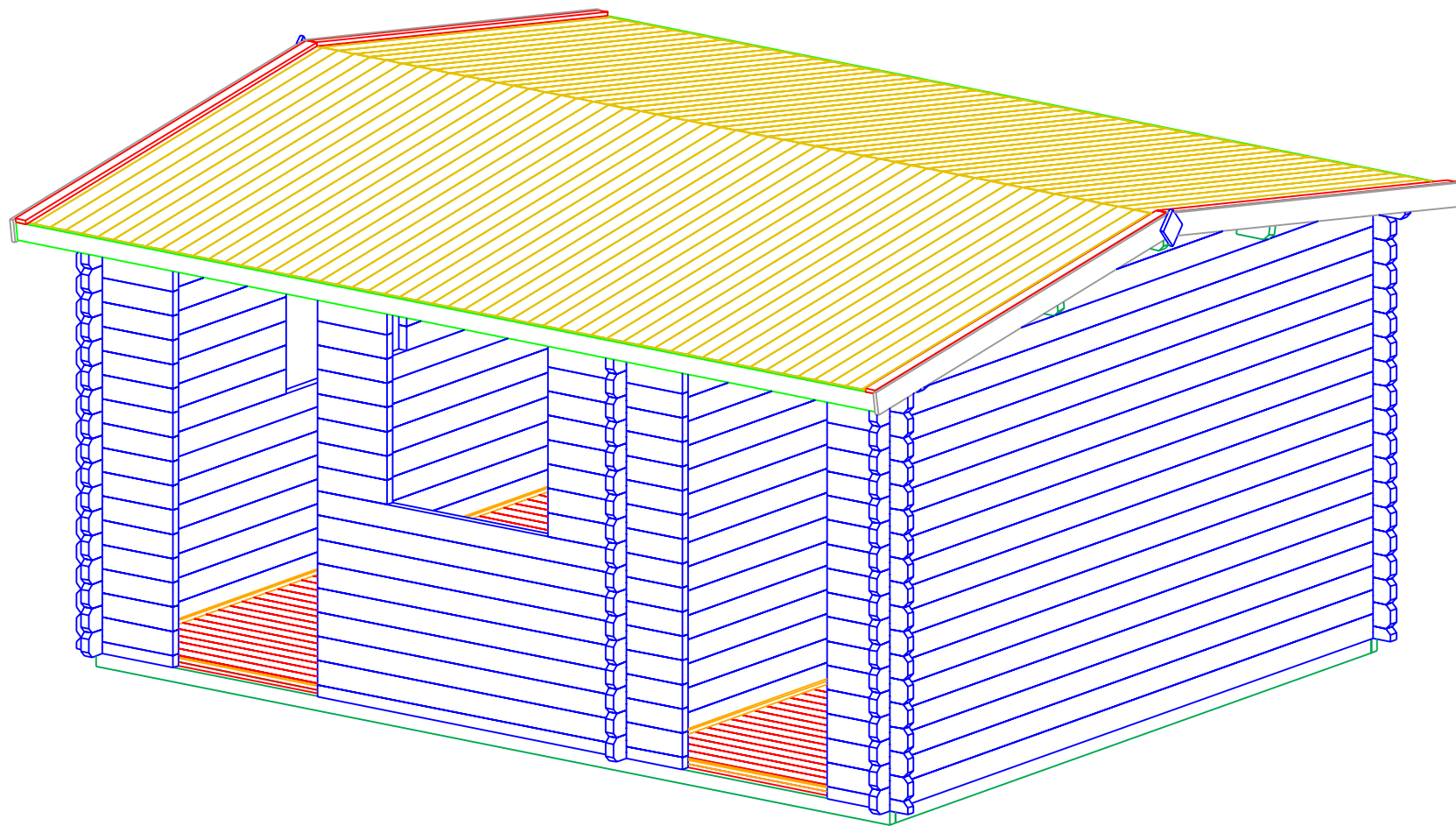

*Barni 44*

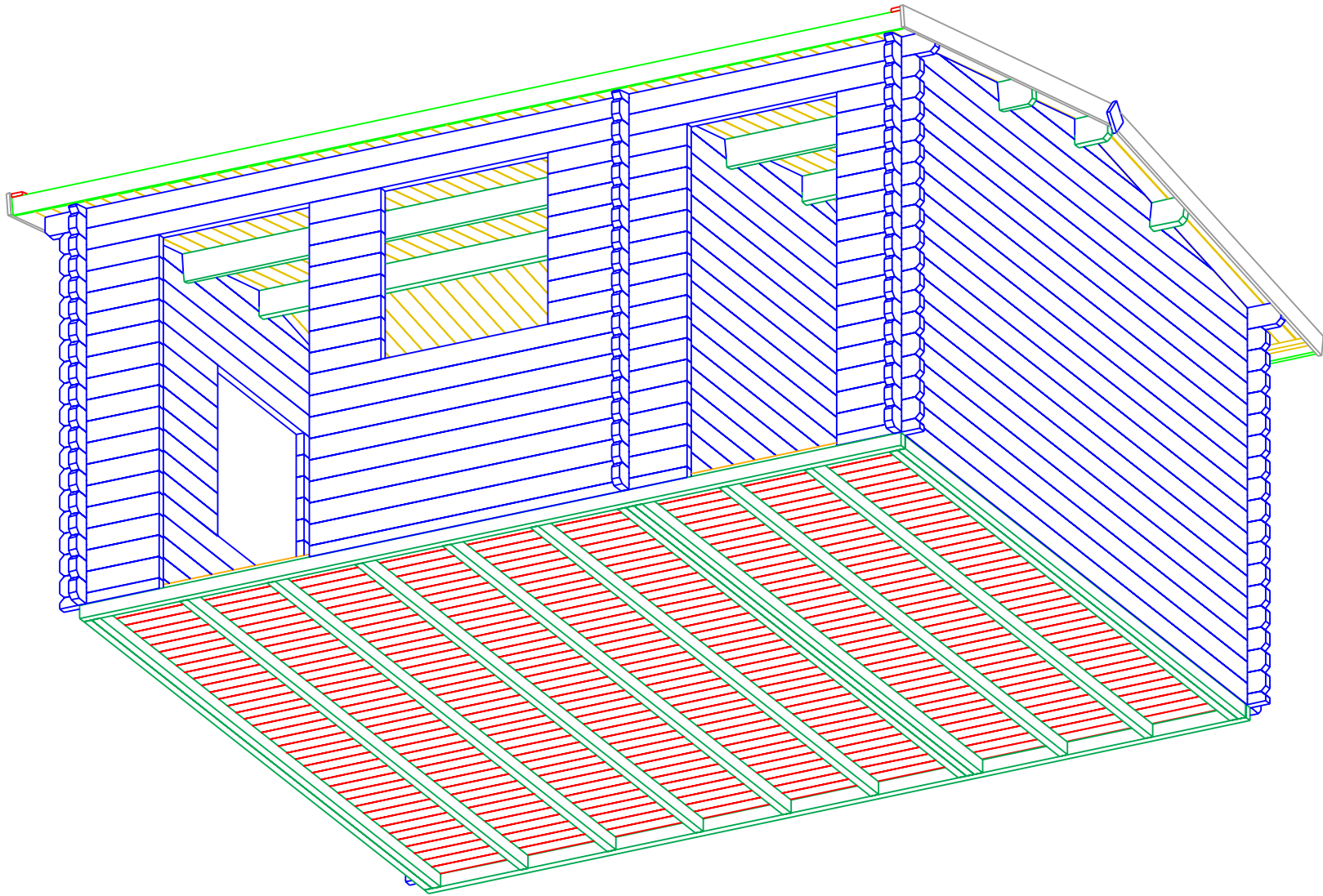

M1:30

Barni 44

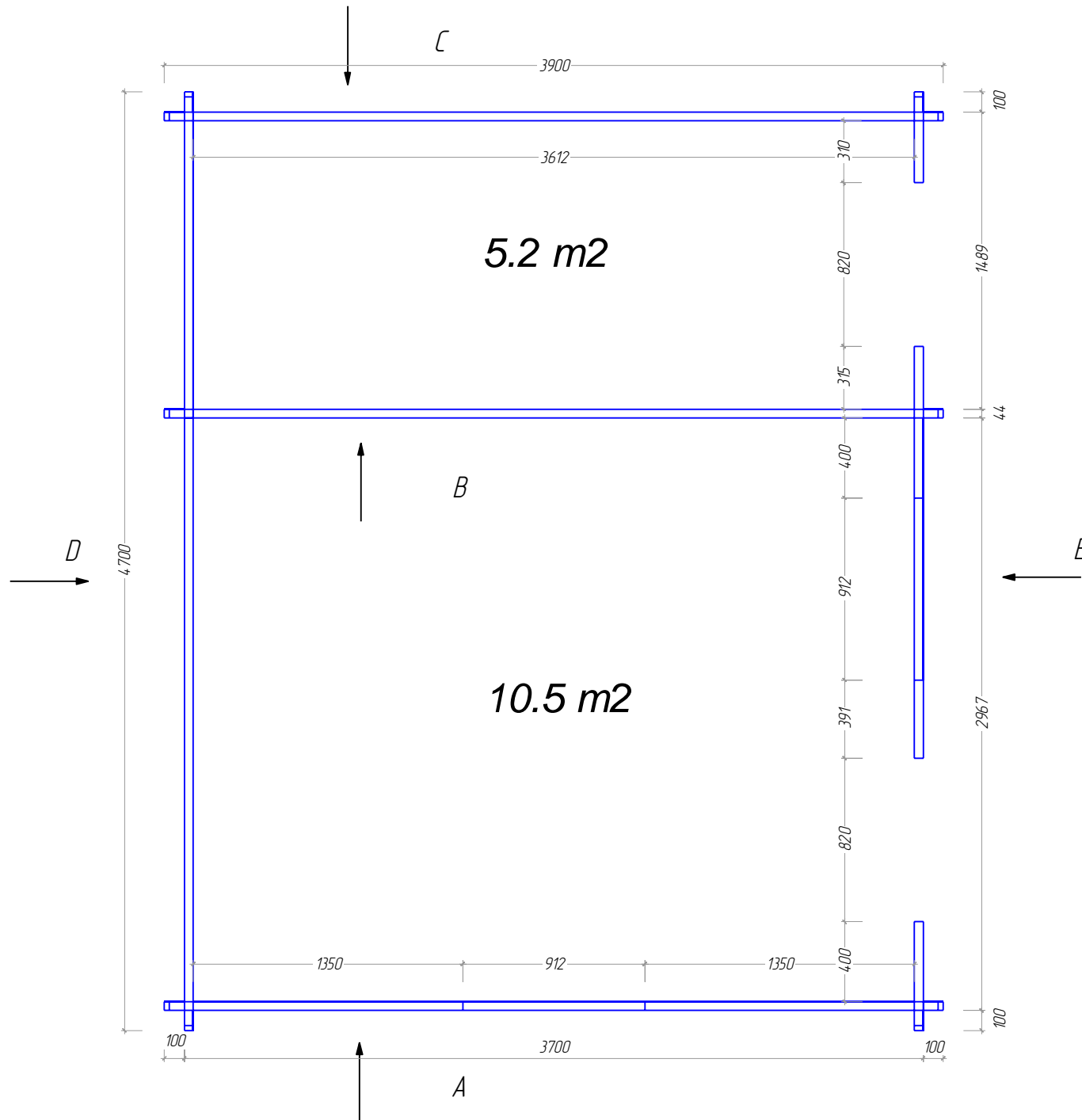

M1:30

Barni 44

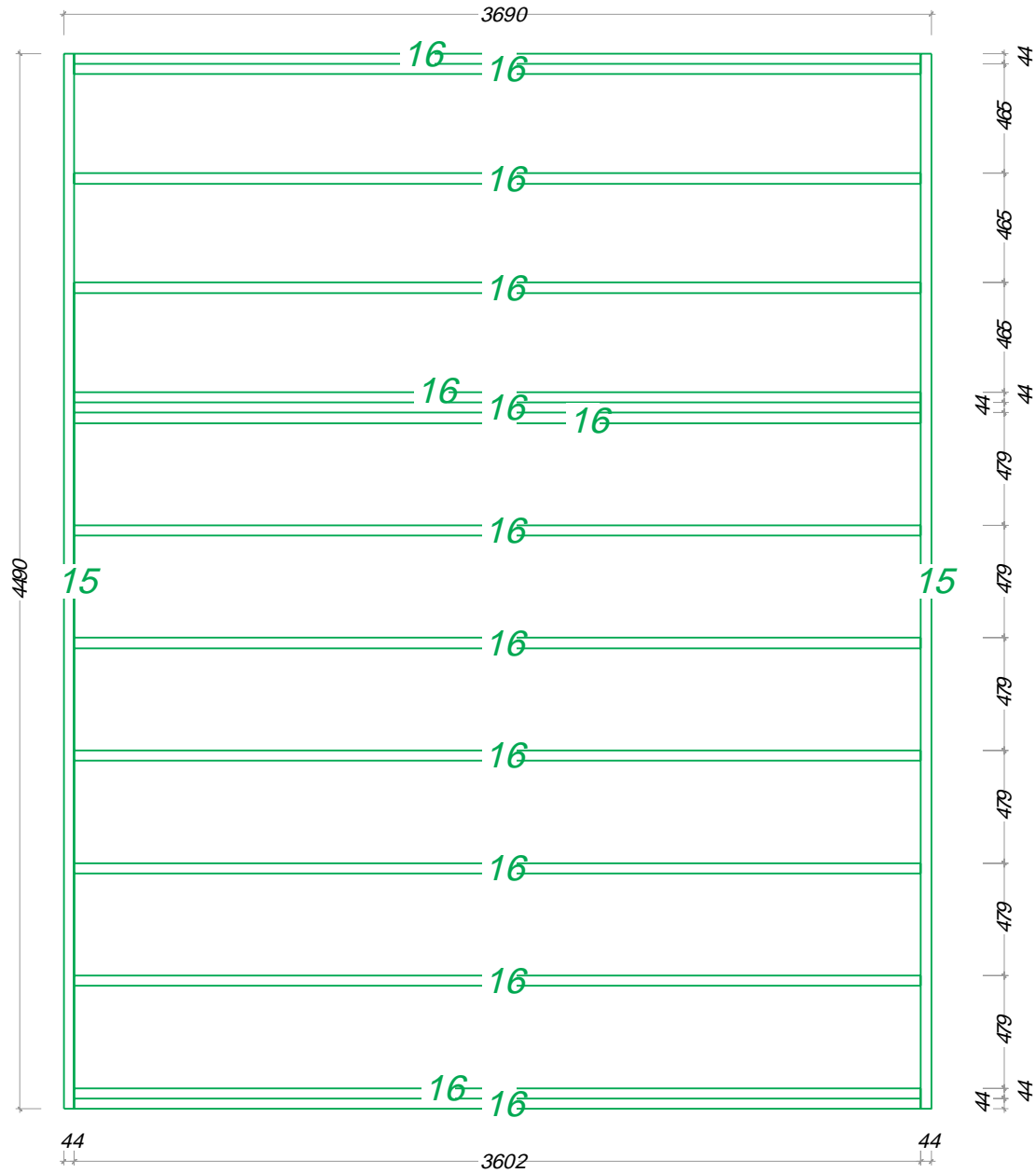

M1:40

Barni 44

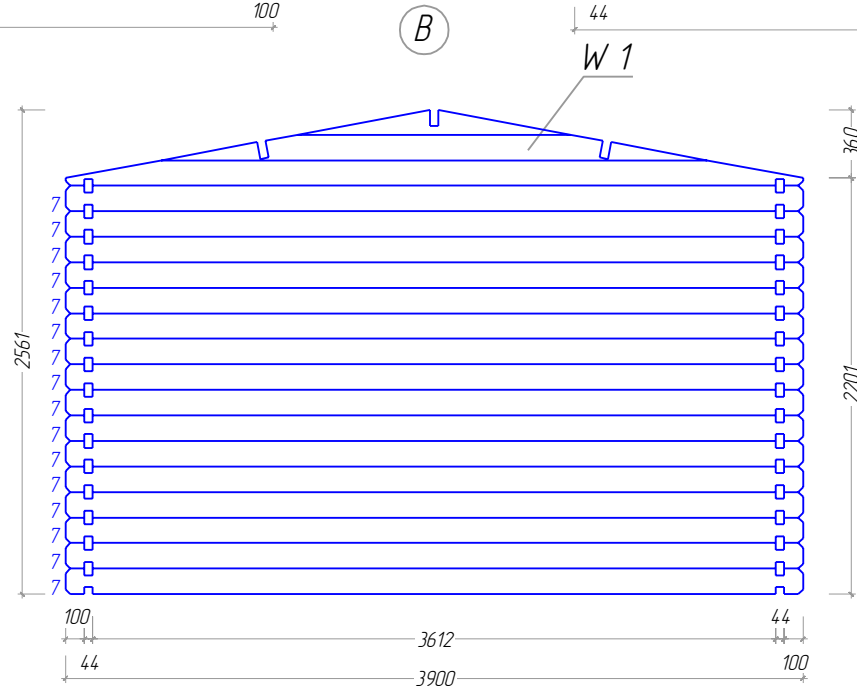
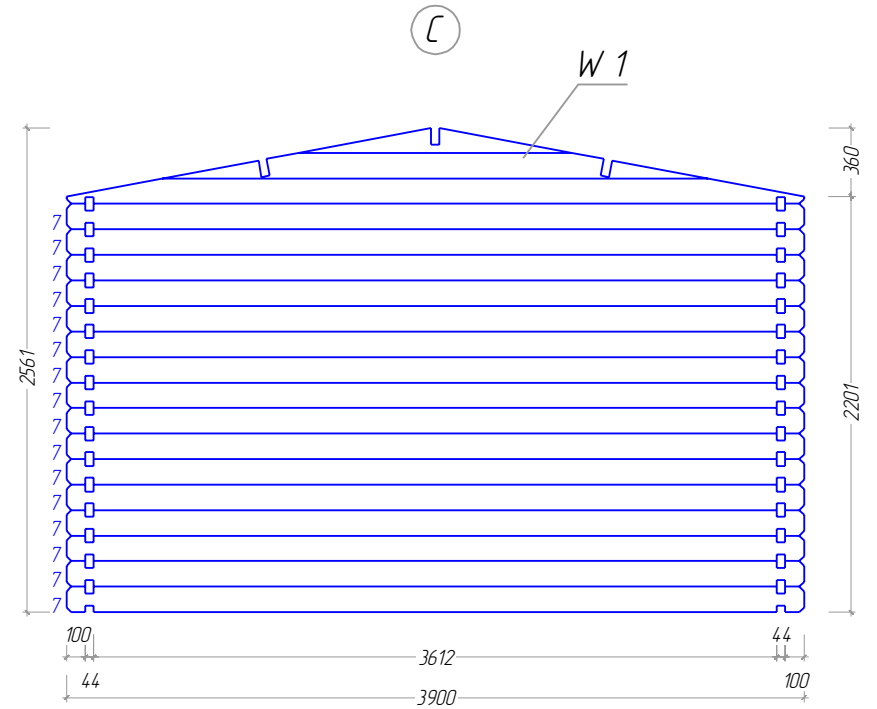
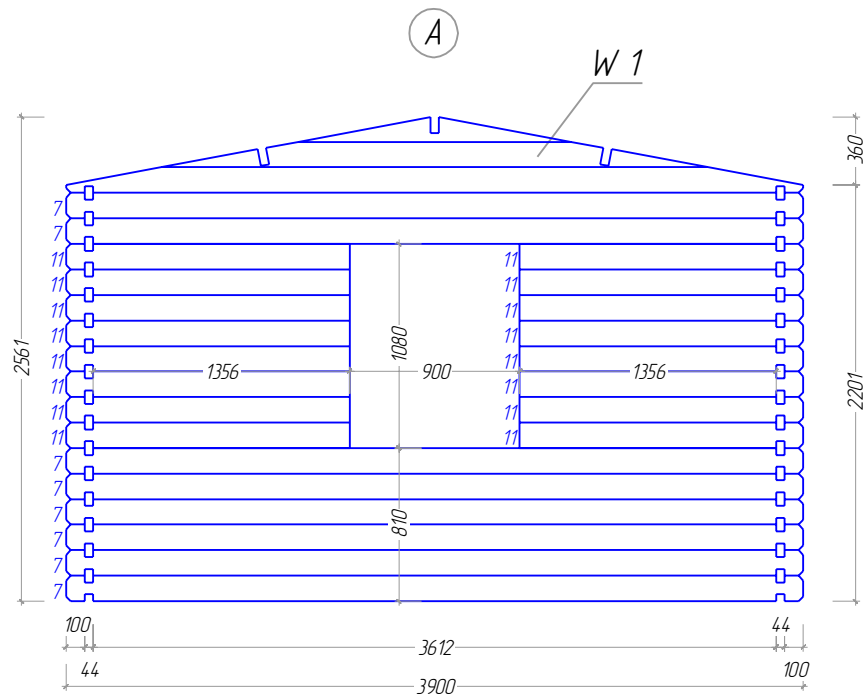

M1:40

Barni 44

D

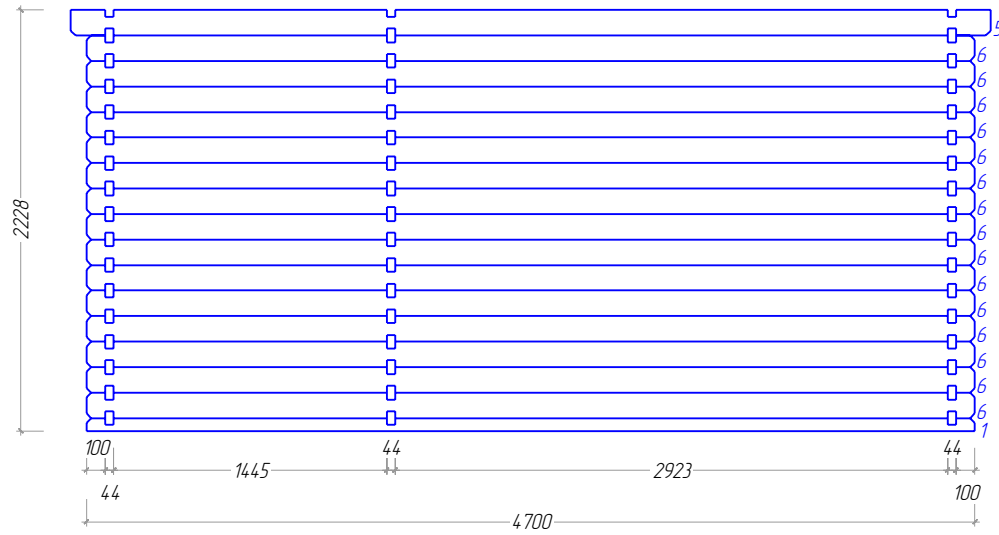

E

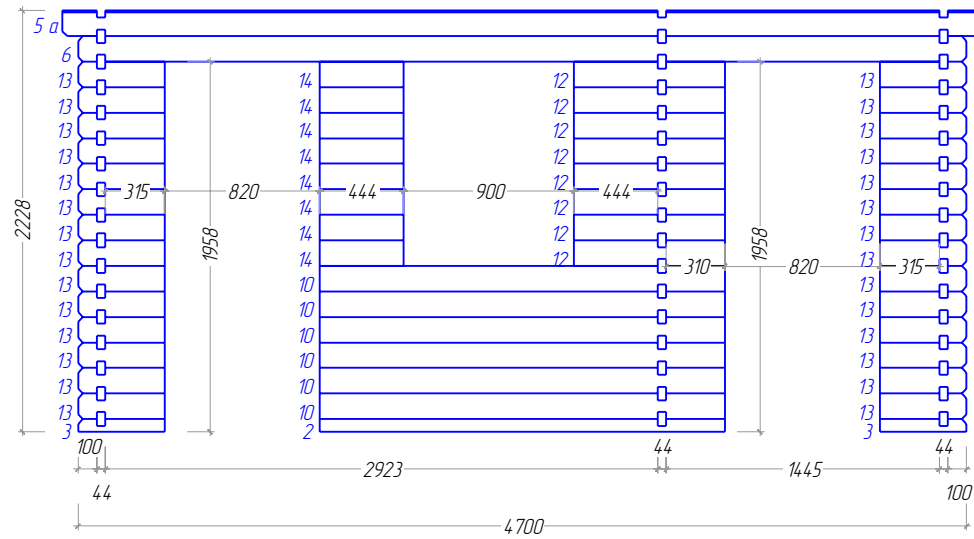

M1:30

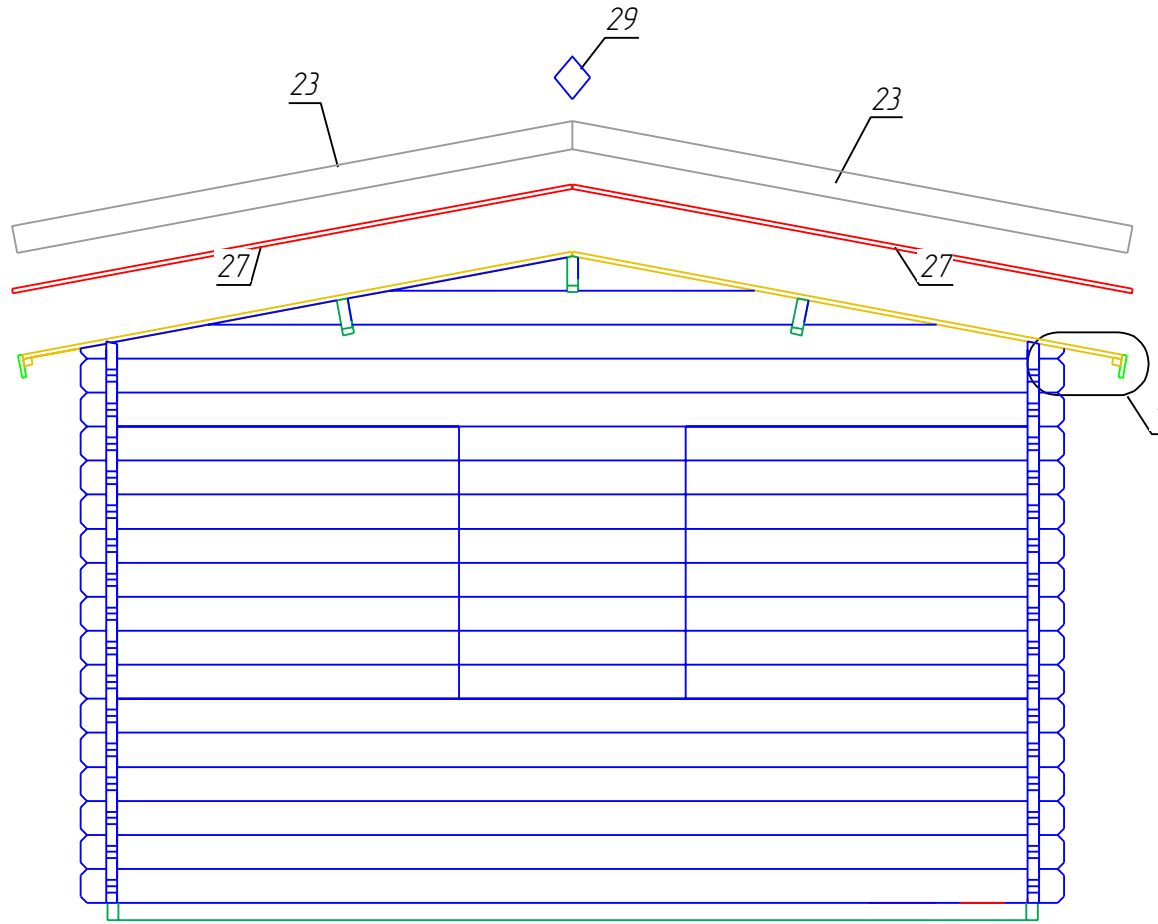

Barni 44

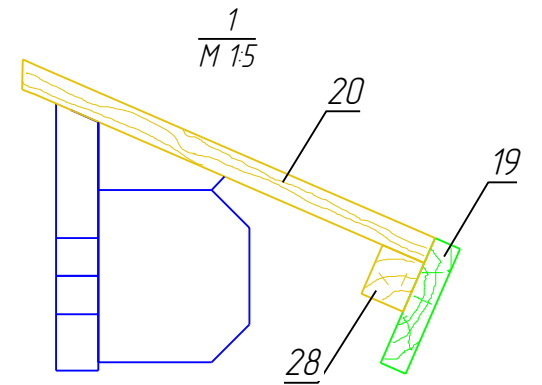



M1:30

Barni 44

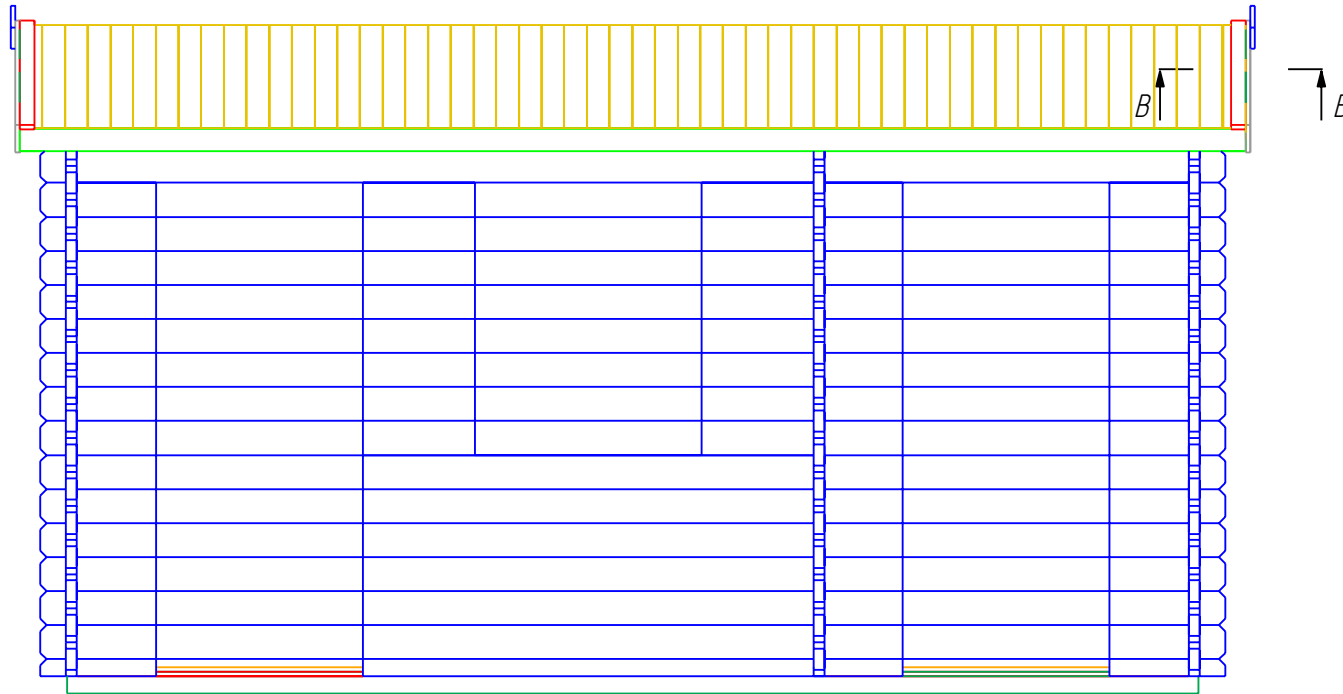

$\frac{B-B}{M 15}$

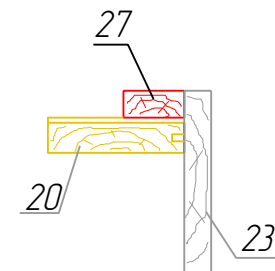

*M1:30*

*Barni 44*

è

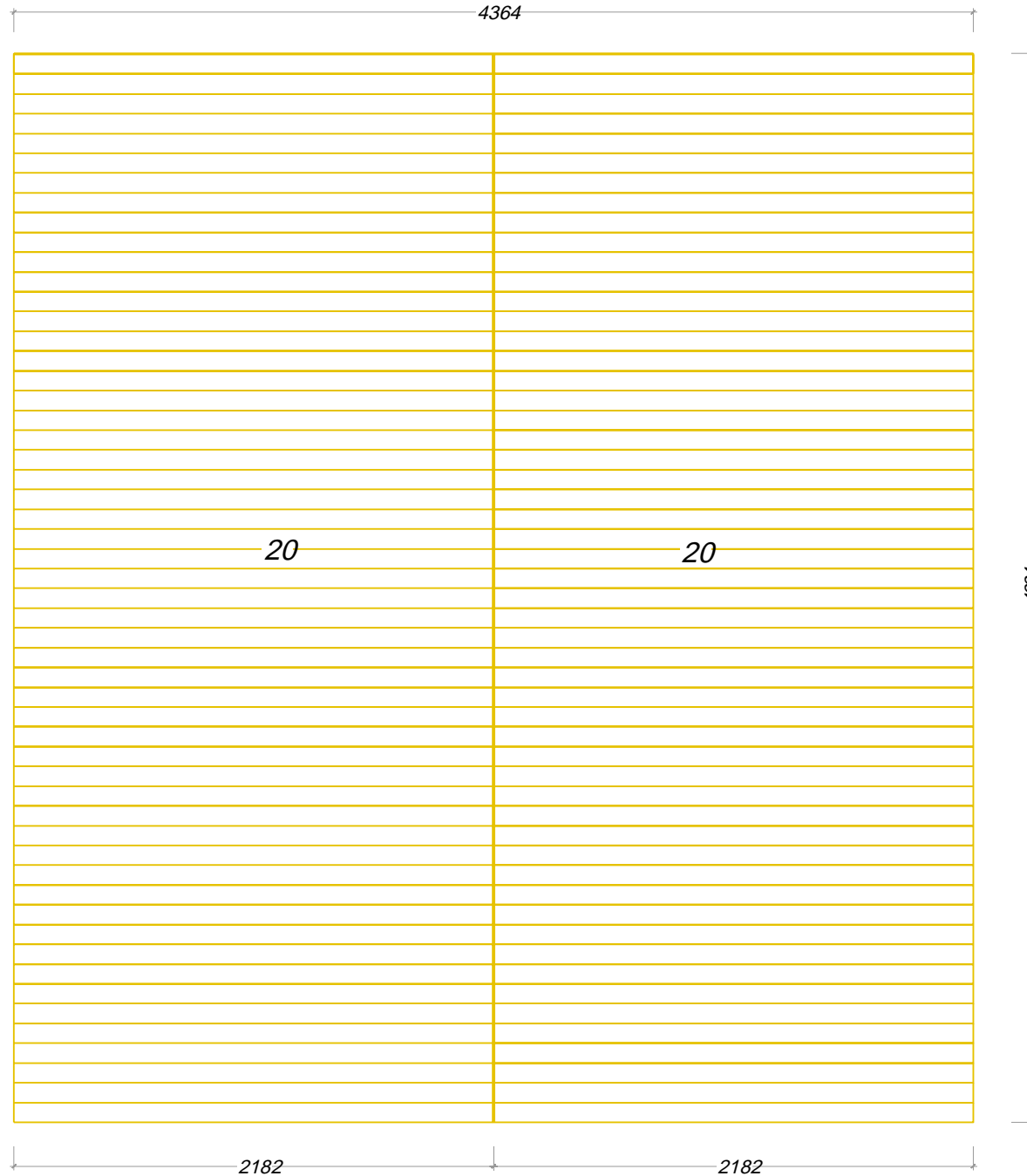





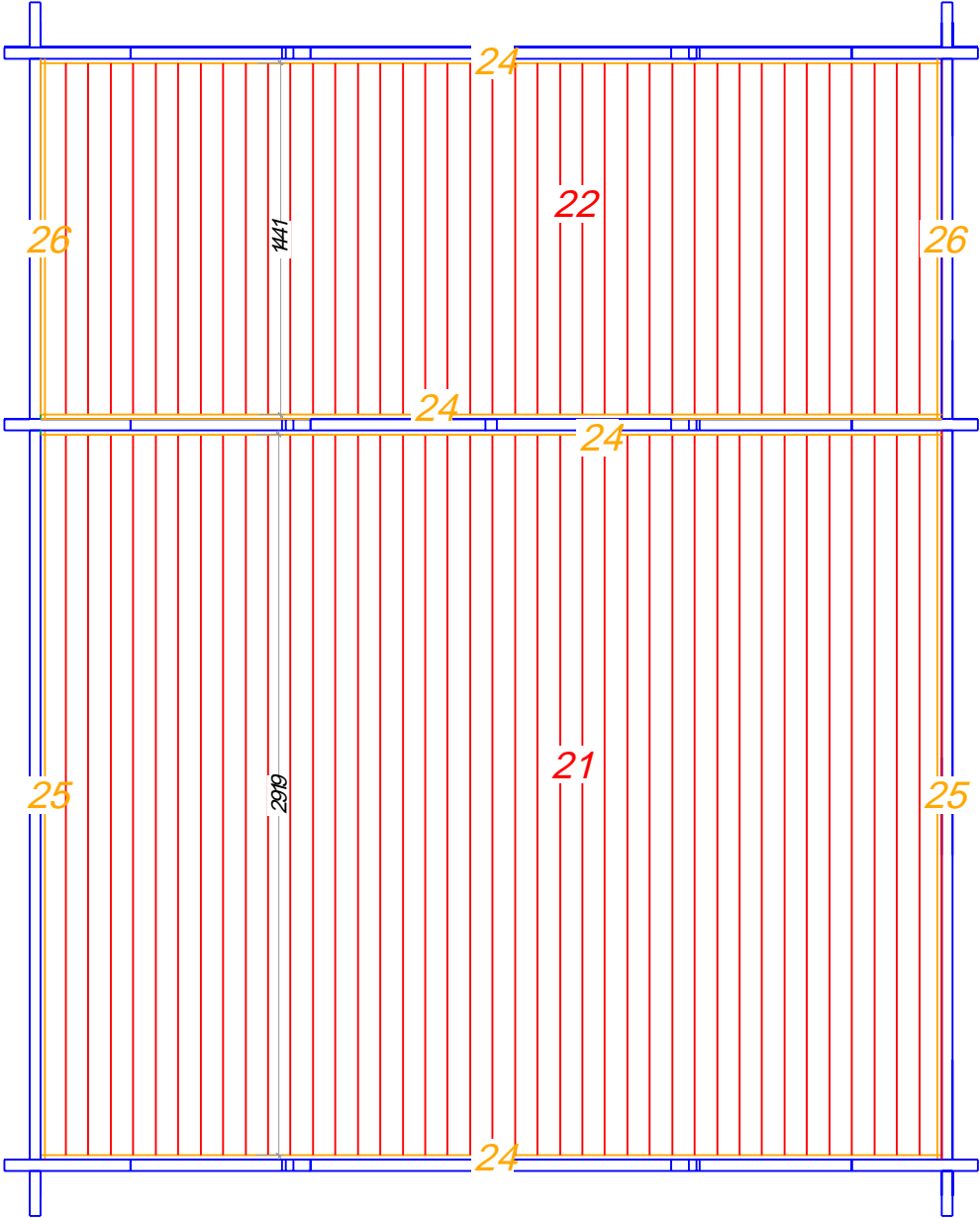





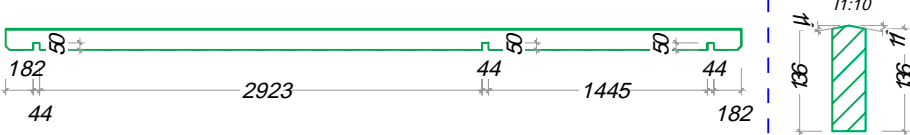

M1:30

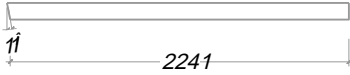
Barni 44



1	<i>Barni 44</i>	M1:50 Poet	ez (mm)	Délka (mm)
1		1	44õ67,5	4700mm
2		1	44õ67,5	2142mm
3		2	44õ67,5	559mm
5		1	44õ135	4864mm
5 à		1	44õ135	4864mm
6		16	44õ135	4700mm
7		40+1	44õ135	3900mm
10		6	44õ135	2142mm
11		16	44õ135	1500mm
12		8	44õ135	798mm
13		28	44õ135	459mm
14		8	44õ135	444mm
15		2	44õ68	4490mm

1	<i>Barni 44</i>	M1:5(Poet	ez (mm)	Délka (mm)
16			14	44ö68 3602mm
17			2	44ö1404864mm
18			1	44ö1404864mm
19		M1:5	4	18ö90 2432mm
20		M1:5	86+1	20ö1152217mm
21		M1:5	32+1	20ö1152919mm
22		M1:5	32	20ö1151441mm
23			4	18ö1102262mm
24		M1:5	4	18ö18 3612mm
25		M1:5	2	18ö18 2923mm
26		M1:5	2	18ö18 1445mm
27		M1:5	4	18ö58 2258mm
28		M1:5	2	28ö34 4864mm

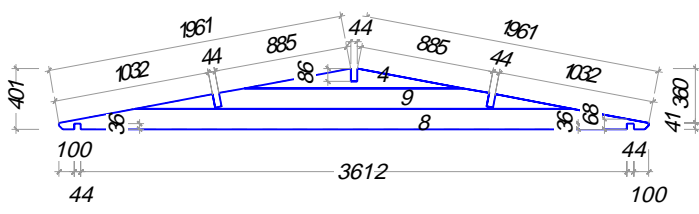
1	Barni 44	M1:50 Poet	(mm)	(mm)
29	◇	2	Ø.18	120mm
W-1	 <p>The drawing shows a cross-section of a roof truss. The main span is 3612 mm. The roof is supported by two vertical posts, each 44 mm high. The truss consists of several members with the following dimensions: top chord segments of 1961 mm, 885 mm, 44 mm, 885 mm, and 1961 mm; bottom chord segments of 1032 mm, 88 mm, 4 mm, 88 mm, and 1032 mm; and vertical members of 401 mm, 36 mm, 8 mm, 36 mm, and 41 mm. The total height of the structure is 441 mm. The base of the structure is 44 mm wide at the center and 100 mm wide at the ends.</p>	3		